

Adult Height Bottle Filling Fountain

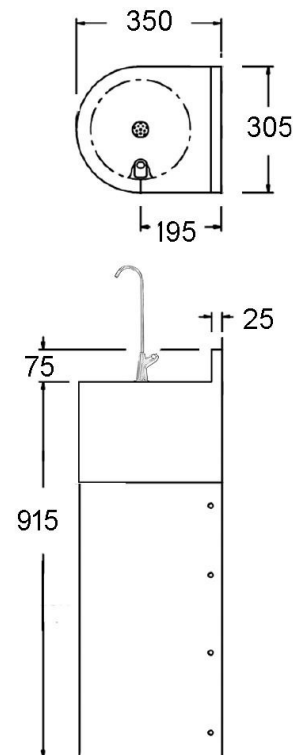

Product Code: DFFSA-CF

Do your bit to help the single use plastic crisis - our range of bottle filling stations are perfect for installation in schools, colleges and universities. Our stainless steel bottle filler offers vandal resistance and the rounded removable under shroud conceals pipework and waste fitting and is retained with security screws.

Supplied with a WRAS approved swan neck bottle/cup filler spout with push button operation. Fitted with a self closing timed flow valve to help prevent any potential wasted water. Complete with integrated wall fixing brackets, these bottle fillers are compact to be installed in suitable locations.

Delivery

Typically 1 to 3 working days

Next working day delivery available for orders placed before 11.30am (at extra cost to standard delivery)

Tech specs

Material: satin finish stainless steel (304 grade, 1.6mm thick)

Width: 300mm

Depth (front to back): 350mm

Height (top to bottom): Junior height 915mm

Rear upstand: 75mm

Waste fittings: 32mm flush grated

Related products

Our junior combined bottle filler and drinking fountains are also available in adult dimensions, perfect secondary school, colleges and academy's.

Drinking fountains and bottle fillers are also available as separate units. From [wall-mounted bottle fillers](#) to [recessed drinking fountains](#), visit our [drinking fountains page](#) to view the whole range.

****All pictures shown are for illustration purpose only and may be subject to change without notice. Actual product may vary due to product enhancement.**

All dimensions shown are for guidance only and may be subject to change or alteration without notice. All items manufactured or purchased separately from a third party to fit our products should be checked against the actual dimensions of the physical product before purchase. We will not be liable for third party costs and consequential loss associated with the items not fitting third party components.**