

## Security Wash Basin Wall Mounted

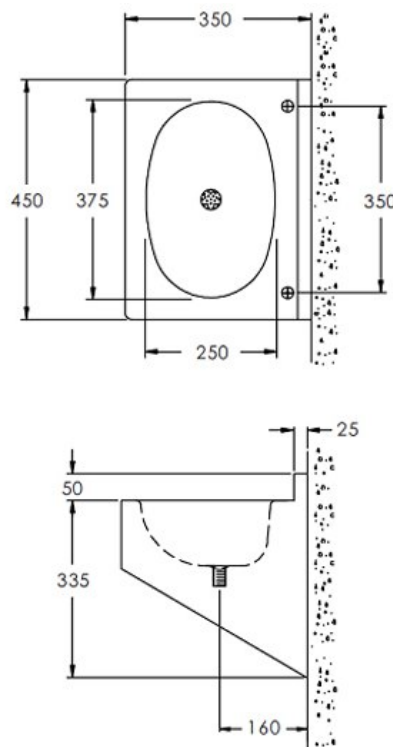

Product Code: SWB

The security wash basin is designed for concealed pipework through the back wall. Concealing the pipework through the back wall gives a neater easily cleaned installation and helps prevent tampering with the service pipework.

The fully shrouded design is easily cleaned and maintained and offers no area that can be tampered with whilst providing a practical hand washing solution.

### Delivery

Typically 1 to 2 working days

### Tech Spec

Width: 450mm  
Front to Back: 350mm  
Height: 335mm with 50mm rear upstand  
Manual foot pump (no electricity required)  
Complete with 32mm flush grated waste (no overflow, plug or chain)  
Two 22mm tap holes  
Stainless steel tap hole blank can be supplied

### Extras

Stainless steel tap hole blank  
Pair cross head taps  
Pair soft touch time flow basin taps  
Single soft touch time flow basin tap (cold)  
Pair lever basin taps  
Lever operated mono bloc mixer tap.

### Related products

We also supply [wall mounted basins](#) in other sizes, or alternatively [inset wash basins](#) to mount into vanity units are available.

**\*\*All pictures shown are for illustration purpose only and may be subject to change without notice. Actual product may vary due to product enhancement. All dimensions shown are for guidance only and may be subject to change or alteration without notice. All items manufactured or purchased separately from a third party to fit our products should be checked against the actual dimensions of the physical product before purchase. We will not be liable for third party costs and consequential loss associated with the items not fitting third party components.\*\***